

BALL VALVES WITH LEVER HANDLE

BV80 Series



BV81-SS shown smaller than actual size.

- ✓ Self Compensating Valve Stem Seal Design Ensures Long, Leak-Tight Maintenance Free Service
- ✓ Full Thread Length Compliance with ANSI B1.20.1 Specification
- ✓ Machined Reinforced PTFE Seats and Stem Seal Standard for Uniform Operating Torque and Long Life
- ✓ Bar Stock Construction Offers Optimum Material Strength and Consistency

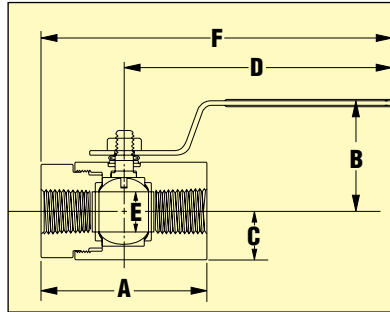

| Valve Size | Dimensions - inches | | | | | |
|------------|---------------------|------|------|------|------|------|
| | A | B | C | D | E | F |
| 1/4 & 3/8 | 2.22 | 1.75 | 0.50 | 4.0 | 0.36 | 5.09 |
| 1/2 | 2.61 | 1.84 | 0.59 | 4.0 | 0.49 | 5.30 |
| 3/4 | 2.94 | 2.00 | 0.75 | 5.38 | 0.62 | 6.85 |
| 1 | 3.32 | 2.28 | 1.00 | 5.38 | 0.80 | 7.04 |
| 1 1/4 | 3.70 | 2.93 | 1.06 | 6.75 | 0.97 | 8.60 |
| 1 1/2 | 4.25 | 3.19 | 1.31 | 6.75 | 1.25 | 8.87 |
| 2 | 4.57 | 3.37 | 1.50 | 6.75 | 1.50 | 9.41 |

SPECIFICATIONS

Materials of Construction Body:
 Brass: ASTM B-16
 316SS: ASTM A276
Ball and Stem: 316 SS
Seats and Stem Seal: Glass Reinforced PTFE
Temperature: -45 to 232°C (-50 to 450°F) (see Pressure Temperature Chart)
Pressure: 49.6 bar (720 psi C.W.P.) [Cold Working Pressure to 65.5°C (150°F)] (see Pressure Temperature Chart)
Vacuum: 20 Micron
Saturated Steam: 10.3 bar (150 psi)

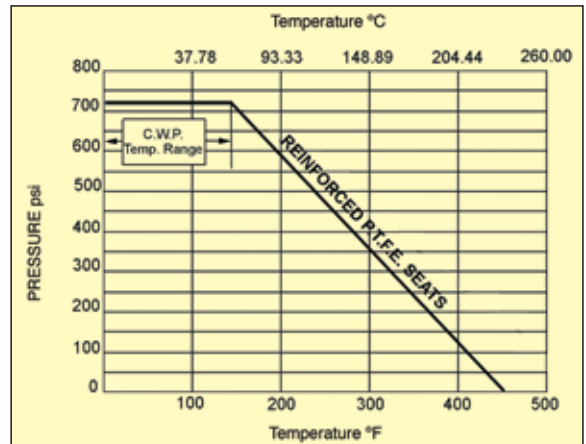

The BV80 Series is a standard port, two-piece body offered in 1/4 thru 2" pipe size. Proper valve selection is dependent on your flow and functional requirements as well as physical size and value considerations.

The BV80 Series, all internal components, including the polymer seats, are precisely machined to strict tolerances, assuring repeated bubble tight sealing and maximum valve life. Our spring loaded stem seal provides automatic compensation for stem seal wear and thermal expansion and contraction. Each valve is bubble tested to ensure reliable, leak tight performance.

The BV80 Series are ideal for automation when coupled to our compact pneumatic or electric actuators.

The BVP80, BVPS80, and BVPE80 series are ball valves coupled to actuators.

To Order

| Brass | 316 Stainless Steel | FNPT |
|-----------|---------------------|-------|
| Model No. | Model No. | Size |
| BV81 | BV81-SS | 1/4 |
| BV82 | BV82-SS | 3/8 |
| BV83 | BV83-SS | 1/2 |
| BV84 | BV84-SS | 3/4 |
| BV85 | BV85-SS | 1 |
| BV86 | BV86-SS | 1 1/4 |
| BV87 | BV87-SS | 1 1/2 |
| BV88 | BV88-SS | 2 |

Comes complete with operator's manual.
Ordering Examples: BV81, 1/4 FNPT ball valve.
 BV85-SS, 1 FNPT 316SS ball valve

