

# THERMOPLASTIC QUICK COUPLINGS

## SUBMINIATURE COUPLING

For 1/16", 1/8" & 3 mm ID tubing, FT-SMC Series

FT-SMC Series



### Features:

- ✓ Leak Free Seal—Replaceable O-Ring Seal Makes a Reliable Pressure or Vacuum Seal
- ✓ Small Size and Clean Appearance—Space Saving Couplings for In-Line, Panel Mount and Pipe Thread Tubing Connections
- ✓ Easy-to-Use Positive Locking—Reliable Snap-Lock Is Quick and Dependable for Vacuum to 100 psi
- ✓ Eliminates Kinking, Twisting and Accidental Unlocking—Design Allows Tubing to Swivel Independent of Locking Mechanism. This Prevents Accidental Unlocking Typical of Luer-Type Connections
- ✓ Corrosion Resistant—Thermoplastic Acetal and Polypropylene are Compatible with FDA and Chemical Applications
- ✓ Single Side Shutoff—Automatically Stops Flow When Coupling is Disconnected. Available for 1/16", 1/8" and 3mm Connectors, Body Side Only
- ✓ Gamma Sterilizable—Available in Polycarbonate

### Applications

- ✓ Medical and Surgical Instrumentation
- ✓ Air Logic Systems
- ✓ Pneumatic Control Systems
- ✓ Disposable Medical Devices



FT-SMC Series quick disconnect couplings bring reliability, economy and added convenience to users of very small flexible plastic tubing.

OMEGA's FT-SMC coupling is a reliable quick connect system for easy servicing and quick component replacement. Available for in line, panel mount and pipe thread configurations. FT-SMC couplings are a reliable alternative to luer-type connections for medical instruments and devices. Their reliable O-Ring seal makes a leak-free connection every time.

† Visit [omega.com/rohs](http://omega.com/rohs) to determine specific RoHS compliance.



Subminiature couplings offer reliable, repeatable sealing capability for space-constrained applications. Shown here actual size.

### FT-SMC Complete In Line Couplings

To Order					
	<b>1/16" X 1/16" Hose Barb</b>				
	<b>ACETAL STRAIGHT THRU MODEL NO.</b>	<b>ACETAL SHUTOFF MODEL NO.</b>	<b>POLYPROPYLENE STRAIGHT THRU MODEL NO.</b>	<b>LENGTH</b>	
				<b>THRU</b>	<b>OFF</b>
	FT-SMC-01	FT-SMCD-01	FT-SMC-01-12	1.32"	1.46"
<b>1/8" X 1/8" Hose Barb – 4 x 4 mm Hose Barb</b>					
FT-SMC-02	FT-SMCD-02	FT-SMC-02-12	1.61"	1.61"	
<b>3 x 3 mm Hose Barb</b>					
FT-SMC-M3	FT-SMCD-M3	—	1.62"	1.62"	

## SPECIFICATIONS

**Working Pressure:** Vacuum to 6.9 bar (100 psi)

**Operating Temperature:**

**Acetal:** -40 to 82°C (-40 to 180°F)

**Polypropylene:** 0 to 82°C (32 to 180°F)

**Materials:**

**Coupling:** Acetal, Polypropylene

**Locking Sleeves:** Acetal

**Shutoff Valves:** Polypropylene

**Valve Spring:** 316 Stainless Steel

**Seals:** Buna with Acetal EPR with Polypropylene

**Tubing Size:** 1/16" and 1/8" ID, 3 mm, 4 mm ID

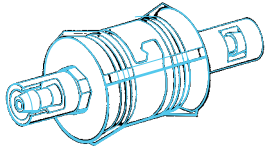

Exclusive 1/16" shrouded hose barb prevents breakage. Patented.

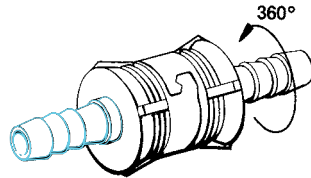

Tubing ends rotate independently of each other.

**Ordering Information:** FT-SMC couplings can be ordered complete for in line applications. For pipe thread and panel mount applications both coupling halves must be specified. For example, a panel mount body coupling (FT-SMFPM-01) requires an insert half of either 1/16", 1/8", 3 or 4 mm to make a complete connection.

## In Line Coupling Halves

### To Order

#### Insert Half

TUBING ID SIZE	METRIC mm ID	ACETAL STRAIGHT THRU MODEL NO.	POLYPROPYLENE SHUTOFF MODEL NO.	STRAIGHT THRU MODEL NO.	LENGTH (inch)
1/16"	—	FT-SMM-01	—	FT-SMM-01-12	1.10
—	3	FT-SMM-M3	—	—	—
1/8"	4	FT-SMM-02	—	FT-SMM-02-12	1.10

#### Body Half

1/16"	—	FT-SMF-01	FT-SMFD-01	FT-SMF-01-12	1.25
—	3	FT-SMF-M3	FT-SMFD-M3	—	—
1/8"	4	FT-SMF-02	FT-SMFD-02	FT-SMF-02-12	1.25

#### Panel Mount Coupling Halves

##### Insert Half

TUBING ID SIZE	METRIC mm ID	ACETAL STRAIGHT THRU MODEL NO.	SHUTOFF MODEL NO.	POLYPROPYLENE STRAIGHT THRU MODEL NO.	LENGTH (inch)
1/16"	—	FT-SMMPM-01	—	FT-SMMPM-01-12	0.90
—	3	FT-SMMPM-M3	—	—	—
1/8"	4	FT-SMMPM-02	—	FT-SMMPM-02-12	0.90

##### Body Half

1/16"	—	FT-SMFPM-01	FT-SMFPMD-01	FT-SMFPM-01-12	0.90
—	3	FT-SMFPM-M3	FT-SMFPMD-M3	—	—
1/8"	4	FT-SMFPM-02	FT-SMFPMD-02	FT-SMFPM-02-12	0.90

#### Pipe Thread Coupling Halves

##### Body Half

TUBING ID SIZE	METRIC mm ID	ACETAL STRAIGHT THRU MODEL NO.	SHUTOFF MODEL NO.	POLYPROPYLENE STRAIGHT THRU MODEL NO.	LENGTH (inch)
1/8" NPT MALE	—	FT-SMPT-02	FT-SMPTD-02	FT-SMPT-02-12	0.86

\* Maximum Panel Thickness = 7/32"; Panel Opening = 7/16".

**Ordering Examples:** FT-SMF-02, body half (pkg of 10), and FT-SMM-02, insert half (pkg of 10). FT-SMCD-01, complete in-line Acetal shutoff (pkg of 10).

