

# SV-10 Series

## PVC Solenoid Valves

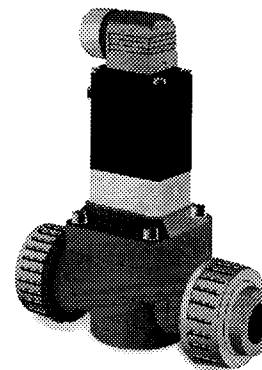

**INSTRUCTION  
SHEET**

**M2195/0695**

### Unpacking Instructions

Remove the Packing List and verify that you have received all equipment, including the following (quantities in parentheses):

- SV-10 Series PVC Solenoid Valves (1)
- Operator's Manual (1)

If you have any questions about the shipment, please call the OMEGA Customer Service Department.

When you receive the shipment, inspect the container and equipment for signs of damage. Note any evidence of rough handling in transit. Immediately report any damage to the shipping agent.

**NOTE**

The carrier will not honor damage claims unless all shipping material is saved for inspection. After examining and removing contents, save packing material and carton in the event shipment is necessary.

### Available Models (Normally Closed Valves)

Part Number	Port Connection (NPT)	C <sub>v</sub>	Pressure Range (PSI)	Orifice Diameter (in)	Weight (lb)
SV-11	1/2	5.8	7-85	9/16	1.4
SV-12	3/4	7.0	7-85	3/4	1.8
SV-13	1	16.3	7-85	1	2.6
SV-14	1-1/4	18.6	7-85	1-1/4	2.6
SV-15	1-1/2	35.0	7-85	1-1/2	4.9
SV-16	2	41.9	7-85	2	4.9

For normally open version, add suffix "-NO" to the part number.  
PVDF versions are available on request.

### Options

Ordering Suffix	Description
-24VDC	24 Vdc operation
-12VDC	12 Vdc operation
-240VAC	240 Vac operation

### Description

The SV-10 Series solenoid valves for corrosive applications use a body material of polyvinylidene fluoride (PVDF) with

### Fluids Handled

Neutral or aggressive gases or liquids which do not attack the valve body material PVDF and PVC (rigid PVC in accordance with DIN 8061 and 8062, resistant) or the selected seal material. Seal material: A = EPDM, B = NBR, F = FPM; see the rating plate. Seal materials is marked on the rating plate after nominal size.

### Attention !

Note permissible pressure range on the rating plate.  
Pressure difference: at least 0.5 bar

Pressure  
[bar]

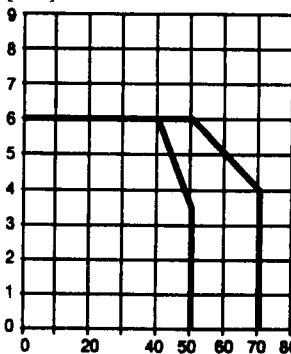

Temperature of Medium [°C]

Ambient temperature: up to + 40 °C

### Installation

Can be installed in any position. Installation with magnet system upright is recommended. Note direction of flow. Stick-on sleeves: Use special Tangit adhesive.

Fusion joint: PVDF

Nuts: Screw on evenly on both sides - by hand only.

Contamination in the piping (seal material, metal chips, etc.) must be removed.

The valve body should not be stressed when installed.

The manual actuator is locked in place by pressing down and turning to the right (clockwise direction). The valve body can be fastened on the bottom.

### Electrical Connection

Note the voltage and type of current indicated on the rating plate. Voltage tolerance of ±10%. Connection via cable connector.

Flat connector lug = ground connection.

Connector: Insert can be turned 4 x 90°; tightening torque is 1 Nm.

### Spare Parts

See chart for spare part sets. Remove pilot valve: Loosen the 2 (non-secured) screws.

Spare Parts

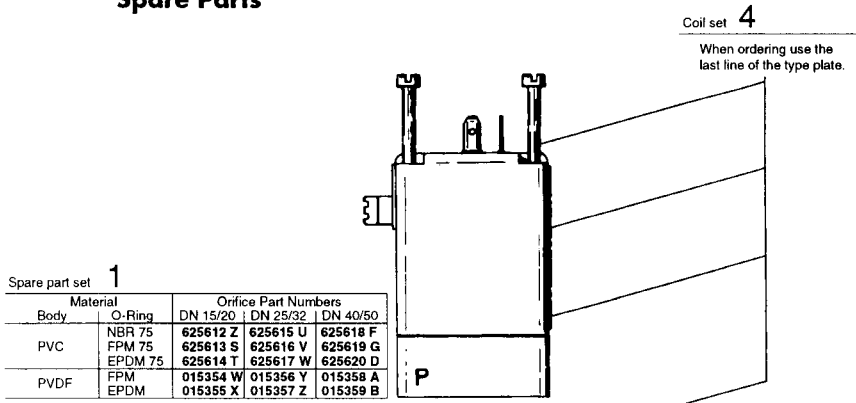

Spare part set 1

Material	O-Ring	Orifice Part Numbers		
		DN 15/20	DN 25/32	DN 40/50
PVC	NBR 75	625612 Z	625615 U	625618 F
	FPM 75	625613 S	625616 V	625619 G
	EPDM 75	625614 T	625617 W	625620 D
PVDF	FPM	015354 W	015356 Y	015358 A
	EPDM	015355 X	015357 Z	015359 B

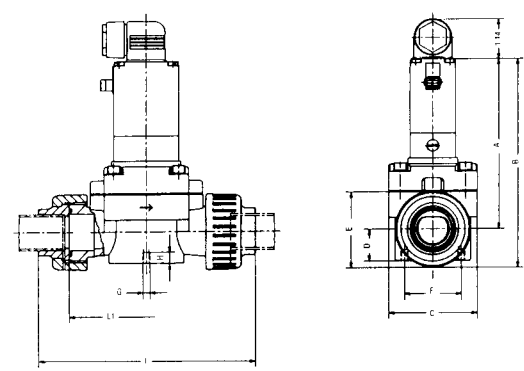

Port NPT	Orifice (IN)	A	B	C	D	E	F	G	H	L	L1
1/2	9/16	4.8	5.8	2.5	0.9	2.1	1.6	M5	0.3	5.8	4.3
3/4	3/4	4.8	5.8	2.5	0.9	2.1	1.6	M5	0.3	6.1	4.3
1	1	5.4	6.9	3.4	1.2	3.0	1.8	M8	0.6	7.5	5.6
1-1/4	1-1/4	5.4	6.9	3.4	1.2	3.0	1.8	M8	0.6	7.8	5.6
1-1/2	1-1/2	5.8	7.9	4.5	1.7	4.1	1.8	M8	0.6	10.0	7.6
2	2	5.8	7.9	4.5	1.7	4.1	1.8	M8	0.6	10.6	7.6

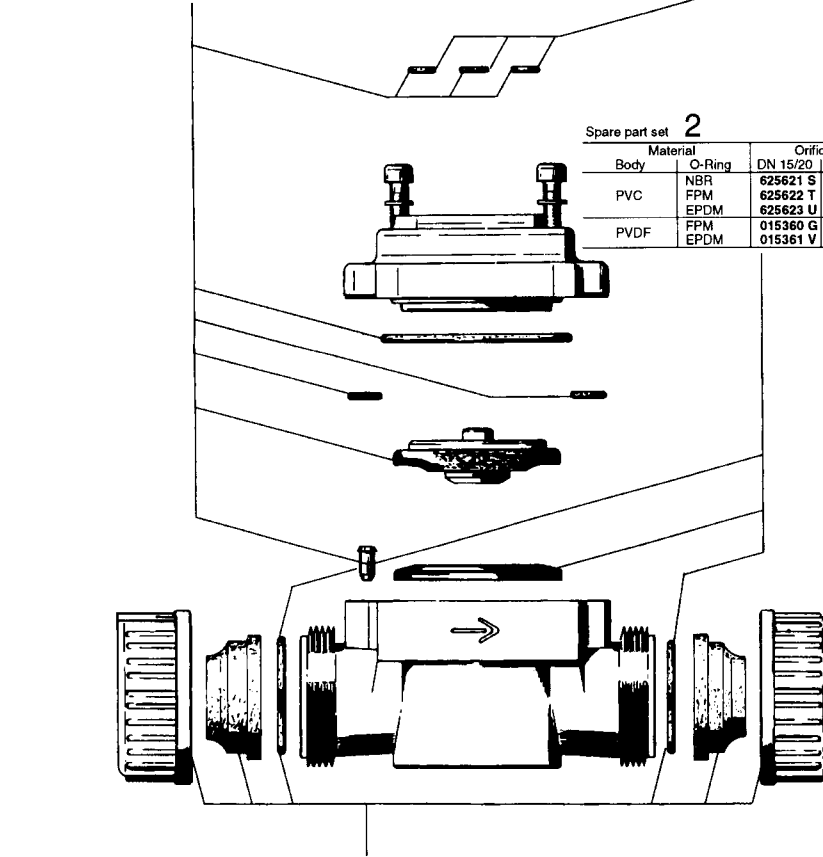

Spare part set 2

Material	O-Ring	Orifice Part Numbers		
		DN 15/20	DN 25/32	DN 40/50
PVC	NBR	625621 S	625624 V	625627 Y
	FPM	625622 T	625625 W	625628 H
	EPDM	625623 U	625626 X	625629 A
PVDF	FPM	015360 C	015362 W	015364 Y
	EPDM	015361 V	015363 X	015365 Z

Specifications

- Mounting Position:** Any (preferably with the coil at the top)
  - Material:** Body and internals PVC
  - Max. Ambient Temp.:** 40°C (104°F)
  - Max. Viscosity:** Approx. 2.3 x 10<sup>4</sup> ft<sup>2</sup>/sec
  - Coil Voltage:** 120 Vac Standard; 12 Vdc, 240 Vdc, 240 Vac optional
  - Voltage Tolerance:** ±10%
  - Power Consumption in Warm State:** ac: 20 VA (inrush); 11 VA/5 W (hold) dc: 5 W
  - Opening Time (msec):** 100-800
  - Closing Time (msec):** 1000-4000
- Response times are measured at nominal pressure of 85 PSI using water and are dependent on orifice and operation of the valve and also on pressure and viscosity of the medium*
- Cycling Rate:** Approx. 10-50 cpm
  - Duty Cycle:** Continuous (100%)
  - Electrical Connection:** F-type connector
  - Dimensions:** See above

Spare part set 3

Material	O-Ring	Orifice Part Numbers					
		DN 15	DN 20	DN 25	DN 32	DN 40	DN 50
PVC	NBR	625630 F	625633 W	625636 Z	625639 C	625642 F	625645 A
	FPM	625631 U	625634 X	625637 S	625640 R	625643 G	625646 B
	EPDM	625632 V	625635 Y	625638 B	625641 E	625644 H	625647 C
PVDF	FPM	015366 S	015368 C	015370 A	015372 Y	015374 S	015376 U
	EPDM	015367 T	015369 D	015371 X	015373 Z	015375 T	015377 V

Conversion Table

DN 15	DN 20	DN 25	DN 32	DN 40	DN 50
↓	↓	↓	↓	↓	↓
9/16"	3/4"	1"	1-1/4"	1-1/2"	2"

WARRANTY

OMEGA warrants this unit to be free of defects in materials and workmanship and to give satisfactory service for a period of **13 months** from date of purchase. OMEGA Warranty adds an additional one (1) month grace period to the normal **one (1) year product warranty** to cover handling and shipping time. This ensures that OMEGA's customers receive maximum coverage on each product. If the unit should malfunction, it must be returned to the factory for evaluation. OMEGA's Customer Service Department will issue an Authorized Return (AR) number immediately upon phone or written request. Upon examination by OMEGA, if the unit is found to be defective, it will be repaired or replaced at no charge. However, this WARRANTY is VOID if the unit shows evidence of having been tampered with or shows evidence of being damaged as a result of excessive corrosion; or current, heat, moisture or vibration; improper specification; misapplication; misuse or other operating conditions outside of OMEGA's control. Components which wear or which are damaged by misuse are not warranted. These include contact points, fuses, and triacs.



Servicing USA and Canada: Call OMEGA Toll Free

USA

One Omega Drive, Box 4147  
Stamford, CT 06907-0147  
Telephone: (203) 359-1660  
FAX: (203) 359-7700

Canada

976 Bergar  
Laval (Quebec) H7L 5A1  
Telephone: (514) 856-6928  
FAX: (514) 856-6886

Sales Service: 1-800-826-6342 / 1-800-TC-OMEGA™  
Customer Service: 1-800-622-2378 / 1-800-622-BEST™  
Engineering Service: 1-800-872-9436 / 1-800-USA-WHEN™  
TELEX: 996404 EASYLINK: 62968934 CABLE: OMEGA

Servicing Europe: United Kingdom Sales and Distribution Center

25 Swanning Road, Broughton Astley, Leicestershire  
LE9 6TU, England  
Telephone: 44 (1455) 285520 FAX: 44 (1455) 283912